



Butterfly valve

- Pressure rating: bidirectional shut-off (150 PSI standard, 230 PSI optional)
- ISO 5211 mounting flange
- Range of body, disc and seat options
- Wafer, lug and flange mount

Product variants described in the data sheet may differ from the product presentation and description.

Can be combined with

	Type 2052 Pneumatic rotary actuator	▶
	Type 2051 Pneumatic rotary actuator	▶
	Type 3003 Electrical Rotary Actuator - On/Off and control	▶
	Type 3004 Explosion-Proof Rotary Actuator - On/Off or Control	▶
	Type 3005 Electrical Rotary Actuator - On/Off and Control	▶
	Type 1061 Position feedback unit for pneumatic rotary actuators	▶
	Type 8792 Digital electropneumatic positioner SideCONTROL	▶

Type description

The Burkert Centric type butterfly valve has many configurations available to meet a wide range of applications. The 2671 Centric type is automation ready with an ISO 5211 mounting pad and stem for direct coupling of the actuator. A full range of actuators, pilot valves, digital positioners, feedback switches and bus network options are available for integration in plant process control systems.

DTS 1000185213 EN Version: | Status: RL (released | freigegeben | valide) printed: 01.04.2026

Table of contents

1. General technical data	3
<hr/>	
2. Materials	4
2.1. Bürkert resistApp	4
2.2. Material specifications	5
Butterfly valve	5
Sizes 1½" ..8"	6
<hr/>	
3. Dimensions	7
3.1. Wafer type, sizes 1½" ..8"	7
3.2. Lug type, sizes 1½" ..8"	8
3.3. Bolting installation	9
3.4. Lever operator and gear operator	10
<hr/>	
4. Performance specifications	11
4.1. C _v value	11
4.2. Expected seating/unseating torque (Nm) including 30% safety factor	11
4.3. Rubber lined butterfly valve specification chart	12
<hr/>	
5. Ordering information	12
5.1. Bürkert eShop	12
5.2. Bürkert product filter	12

DTS 1000185213 EN Version: | Status: RL (released | freigegeben | valide) printed: 01.04.2026

1. General technical data

Product properties	
Dimensions	Further information can be found in chapter "3. Dimensions" on page 7.
Material	
Seal	PTFE
Body	Cast iron, ductile iron, stainless steel, alu-bronze
Disc	Ductile iron (Nylon 11 coated), stainless steel (304 SS, 316 SS)
Stem	NBR, EPDM, EPT, neoprene, silicon, CSM, FKM, 410 SS, 604 SS, stainless steel 1.4401/316
Performance data	
Nominal pressure	Bidirectional bubble-tight shut-off to 150 PSI, 230 PSI (optional)
Medium data	
Medium temperature	- 4 °F...+ 400 °F, based on valve seat limit
Operating medium	Compatible with materials of construction and pressure / temperature limits of seals and disc
Product connections	
Port connection	1½"...8" wafer and lug style
Environment and installation	
Installation	As required

Face-to-Face

Valve bodies are designed to meet ISO 5752, Table 5 (Short Pattern).

Top Works

- 24" and below: Valve mounting flange and stem shall be per ISO 5211.
- 28" and above: Valve mounting flange per ISO 5211; stem shall be round keyed.

Flange Requirements

- Wafer type/lug type: ANSI 125/150, BS Table E, JIS 10K, DIN PN 10, DIN PN 16.
- All wafer valves have locating holes for ease of installation.
- Flanged type: ANSI 150, JIS 10K, DIN PN 10, DIN PN 16.

Pressure Rating

Bidirectional, bubble-tight shutoff up to:

- 230 psi – 1½"...24"
- 150 psi – 26"...40"

Seat tested to 110% of full rating:

- 260 psi – 1½"...24"
- 160 psi – 26"...40"

Shell Testing

The valve body strength withstands 150% of full pressure rating:

- 340 psi – 1½"...24"
- 220 psi – 26"...40"

Installation Instructions

The valve is designed for installation between flat-face or raised-face flanges. Do not use flange gaskets. The butterfly valve design eliminates the need for gaskets.

For proper installation, ensure that the space between flanges is sufficient to allow valve insertion without disturbing the rubber liner flange seal. Note that the disc sealing edge is aligned with the flat of the shaft. Rotate the stem to position the disc fully within the body, place the valve between the flanges, and hand-tighten the bolts. Slowly open the valve counterclockwise to check for adequate disc clearance. Return the disc to the 10° open position, then cross-tighten all bolts. Recheck for adequate disc clearance.

Stem Retaining Mechanism

For valve sizes 14" and below, the stem is retained in the body by a special "Q"-type design, allowing the stem to be removed from the body and disc without special tools. Unless disassembly is intended, do not position the disc at approximately 135°.

Anti-Condensation

Available upon customer request.

2. Materials

2.1. Bürkert resistApp

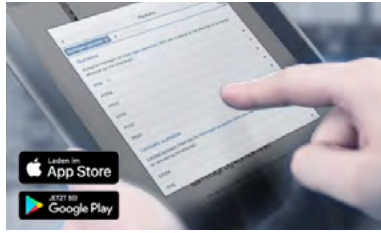

Bürkert resistApp – Chemical resistance chart

You want to ensure the reliability and durability of the materials in your individual application case? Verify your combination of media and materials on our website or in our resistApp.

[Start chemical resistance check](#)

2.2. Material specifications

Butterfly valve

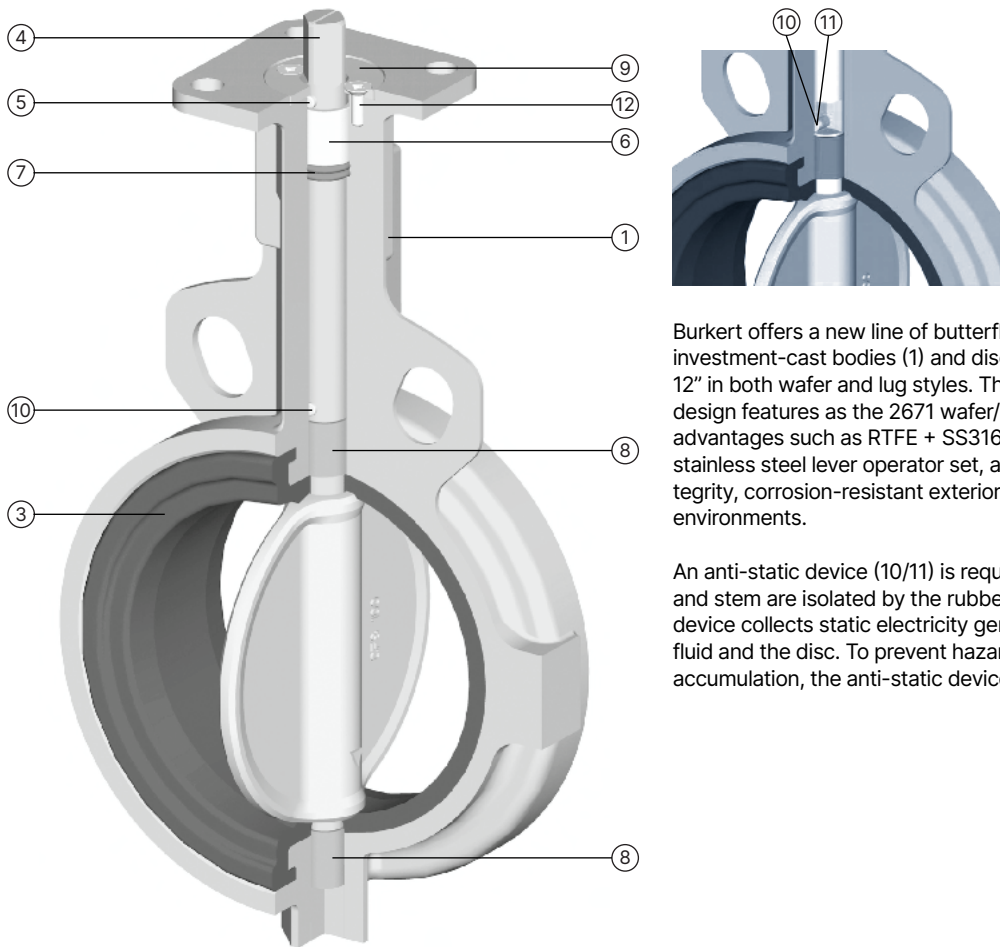

Burkert offers a new line of butterfly valves with stainless steel, investment-cast bodies (1) and discs (2), available in sizes from 1½" to 12" in both wafer and lug styles. This valve line incorporates the same design features as the 2671 wafer/lug-style valve, with additional advantages such as RTFE + SS316 bushings (8), a stem retainer (9), a stainless steel lever operator set, and a gearbox, providing a high-integrity, corrosion-resistant exterior suitable for use in aggressive environments.

An anti-static device (10/11) is required for this valve, as the valve disc and stem are isolated by the rubber liner and stem bushings. The device collects static electricity generated by friction between the fluid and the disc. To prevent hazards caused by static charge accumulation, the anti-static device is essential.

No.	Element	Material	Specification		Comment
			JIS	ASTM	
1	Body	Stainless steel	SCS 13A	A351 Gr. CF8	–
			SCS 14A	A351 Gr. CF8M	–
2	Disc	Stainless steel	SCS 13A	A351 Gr. CF8	–
			SCS 14A	A351 Gr. CF8M	–
3	Seat	NBR (Nitrile)	–	–	+ 14 °F...+ 176 °F (- 10 °C...+ 80 °C)
		EPDM	–	–	- 4 °F...+ 248 °F (- 20 °C...+ 120 °C)
		EPT	–	–	- 4 °F...+ 284 °F (- 20 °C...+ 140 °C)
		Neoprene (CR)	–	–	+ 32 °F...+ 176 °F (0 °C...+ 80 °C)
		Silicon	–	–	- 4 °F...+ 356 °F (- 20 °C...+ 180 °C)
		CSM	–	–	- 4 °F...+ 275 °F (- 20 °C...+ 135 °C)
		FKM	–	–	- 0.4 °F...+ 400 °F (- 18 °C...+ 204 °C)
4	Stem	Stainless steel	SUS 410	A182 Gr. F6A	–
			SUS 304	A182 Gr. F304	–
			SUS 316	A182 Gr. F316	–
5	Pin	Stainless steel	SUS 304	A182 Gr. F304	–
6	Bush	Delrin	–	–	–
7	O-ring	NBR (Nitrile)	–	–	–
8	Bush	RPTFE+Stainless steel	RPTFE+SUS316	RPTFE+A240 Gr. 316	–
9	Stem retainer	Stainless steel	SUS 304	A240 Gr. F304	–
10	Pin (anti-static)	Stainless steel	SUS 304	A182 Gr. F304	–
11	Spring	Stainless steel	SUS 304	A182 Gr. F304	–
12	Screw	Stainless steel	SUS 304	A193 Gr. B8	–

DTS 1000185213 EN Version: | Status: RL (released | freigegeben | valide) printed: 01.04.2026

Sizes 1½"...8"

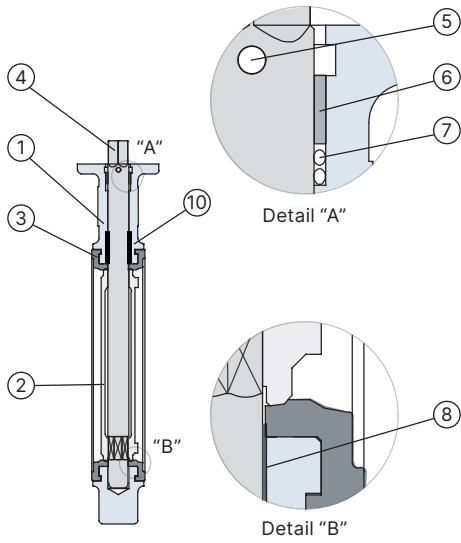

No.	Element	Material	Specification		Comment
			JIS	ASTM	
1	Body	Cast iron	FC 200	A126 Cl. B	1½"...24"
		Ductile iron	FCD 400	A395	1½"...24"
		Stainless steel	SCS 13A	A351 Gr. CF8	14"...24"
SCS 14A	A351 Gr. CF8M		14"...24"		
2	Disc	Ductile iron	FCD 400	A395	Nylon 11 coated
		Stainless steel	SCS 13	A351 Gr. CF8	
			SCS 14A	A351 Gr. CF8M	
3	Seat	NBR (Nitrile)	-	-	+ 14 °F...+ 176 °F (- 10 °C...+ 80 °C)
		EPDM	-	-	- 4 °F...+ 248 °F (- 20 °C...+ 120 °C)
		EPT	-	-	- 4 °F...+ 284 °F (- 20 °C...+ 140 °C)
		Neoprene (CR)	-	-	32 °F...+ 176 °F (0 °C...+ 80 °C)
		Silicon	-	-	- 4 °F...+ 356 °F (- 20 °C...+ 180 °C)
		CSM	-	-	- 4 °F...+ 275 °F (- 20 °C...+ 135 °C)
		FKM	-	-	- 0.4 °F...+ 400 °F (- 18 °C...+ 204 °C)
4	Stem	Stainless steel	SUS 410	A182 Gr. F6A	-
			SUS 304	A182 Gr. F304	-
			SUS 316	A182 Gr. F316	-
5	Pin	Stainless steel	SUS 304	A182 Gr. F304	-
6	Bush	Delrin	-	-	-
7	O-ring	NBR (Nitrile)	-	-	-
8	Bush	Bronze	BC6	B62	For cast iron and ductile iron body

DTS 1000185213 EN Version: | Status: RL (released | freigegeben | valide) printed: 01.04.2026

3. Dimensions

3.1. Wafer type, sizes 1½" ...8"

Note:

Dimensions in mm

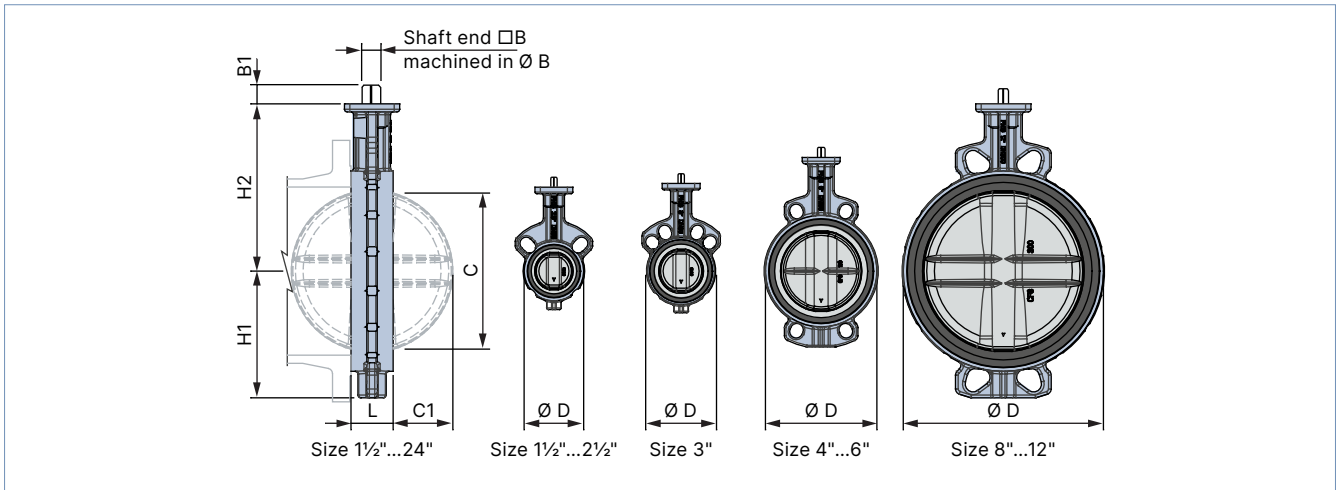

Size		Face to face				Disc clearance		Mounting flange (ISO 5211)		Shaft end				Weight
		L	H1	H2	D	C	C1	Type	PCD	Ø B	□ B	B1	Key	
[mm]	[inch]	[mm]	[mm]	[mm]	[mm]	[mm]	[mm]			[mm]	[mm]	[mm]		[lbs]
40	1½"	33	60	120	81	34	7	F07	70	14	11	19	-	6.6
50	2"	43	65	143	96	39	8	F07	70	14	11	19	-	9
65	2½"	46	71	155	110	55	13	F07	70	14	11	19	-	9
80	3"	46	77	162	124	69	19	F07	70	14	11	19	-	11
100	4"	52	107	181	148	91	27	F07	70	14	11	19	-	18
125	5"	56	122	197	180	115	36	F07	70	18	14	19	-	22
150	6"	56	150	210	206	140	47	F07	70	18	14	19	-	24
200	8"	60	165	240	259	186	68	F10	102	22	17	24	-	40

DTS 1000185213 EN Version: I Status: RL (released | freigegeben | valide) printed: 01.04.2026

3.2. Lug type, sizes 1½"…8"

Note:

Dimensions in mm

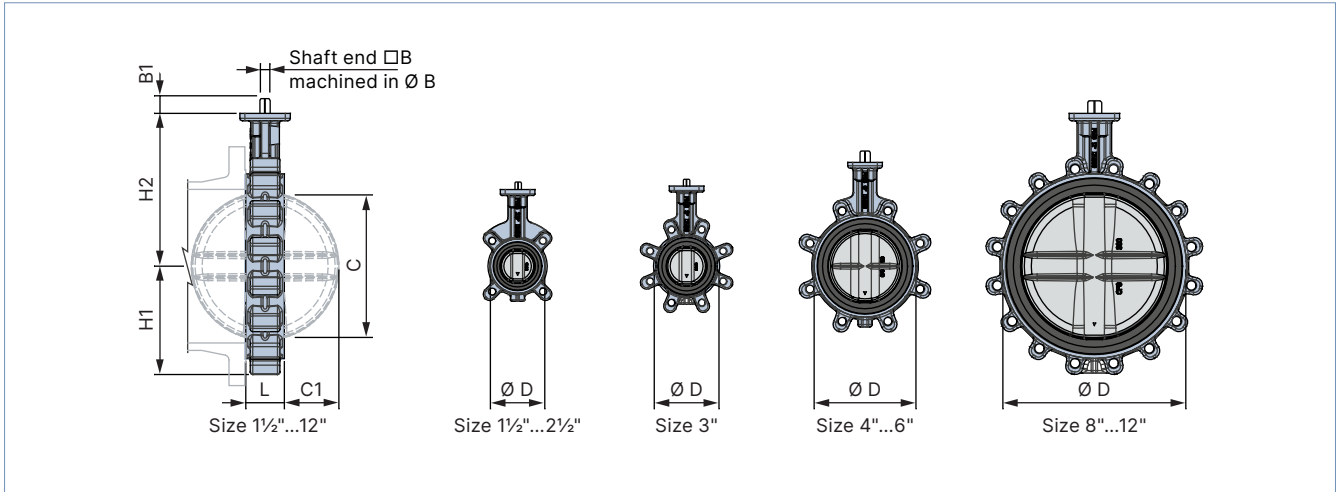

Size		Face to face				Disc clearance		Mounting flange (ISO 5211)		Shaft end			Weight
		L	H1	H2	D	C	C1	Type	PCD	Ø B	□ B	B1	
[mm]	[inch]	[mm]	[mm]	[mm]	[mm]	[mm]	[mm]			[mm]	[mm]	[mm]	[lbs]
40	1½"	33	60	120	81	34	7	F07	70	14	11	19	6.6
50	2"	43	65	143	96	39	8	F07	70	14	11	19	9
65	2½"	46	71	155	110	55	13	F07	70	14	11	19	9
80	3"	46	77	162	124	69	19	F07	70	14	11	19	11
100	4"	52	89	181	148	91	27	F07	70	14	11	19	18
125	5"	56	112	197	180	115	36	F07	70	18	14	19	22
150	6"	56	123	210	206	140	47	F07	70	18	14	19	24
200	8"	60	150	240	259	186	68	F10	102	22	17	24	40

DTS 1000185213 EN Version: | Status: RL (released | freigegeben | valide) printed: 01.04.2026

3.3. Bolting installation

Note:

Dimensions in mm

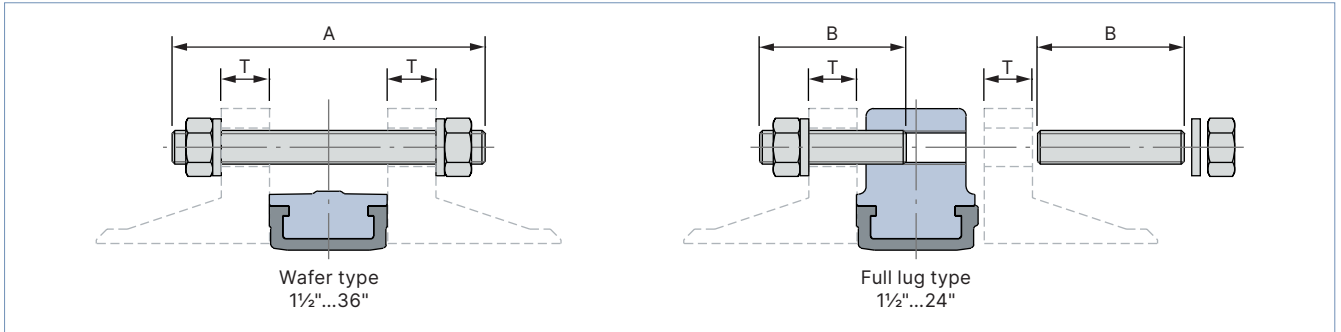

Size		PN 10					PN 16					ASME B16.5 class 150 ASME B16.47 class 150 series A					JIS 10K					
		Bolt size	A	B	C	T	Bolt size	A	B	C	T	Bolt size	A	B	C	T	Bolt size	A	B	C	T	
[mm]	[inch]	[mm]	[mm]	[mm]	[mm]	[mm]	[mm]	[mm]	[mm]	[mm]	[mm]	[mm]	[mm]	[mm]	[mm]	[mm]	[mm]	[mm]	[mm]	[mm]	[mm]	[mm]
40	1½"	M16	115	35	-	18	M16	115	35	-	18	½"	105	35	-	18	M16	110	35	-	16	
50	2"	M16	130	40	-	20	M16	130	40	-	20	⅝"	125	40	-	19	M16	120	40	-	16	
65	2½"	M16	130	45	-	20	M16	130	45	-	20	⅝"	135	45	-	22	M16	125	45	-	18	
80	3"	M16	130	45	-	20	M16	130	45	-	20	⅝"	140	45	-	24	M16	125	45	-	18	
100	4"	M16	140	50	-	22	M16	140	50	-	22	⅝"	145	50	-	24	M16	135	45	-	18	
125	5"	M16	145	50	-	22	M16	145	50	-	22	¾"	155	55	-	24	M20	145	55	-	20	
150	6"	M20	160	55	-	24	M20	160	55	-	24	¾"	160	55	-	25	M20	155	55	-	22	
200	8"	M20	165	55	-	24	M20	160	55	-	24	¾"	170	60	-	28	M20	160	55	-	22	

DTS 1000185213 EN Version: | Status: RL (released | freigegeben | valide) printed: 01.04.2026

3.4. Lever operator and gear operator

Note:

Dimensions in mm

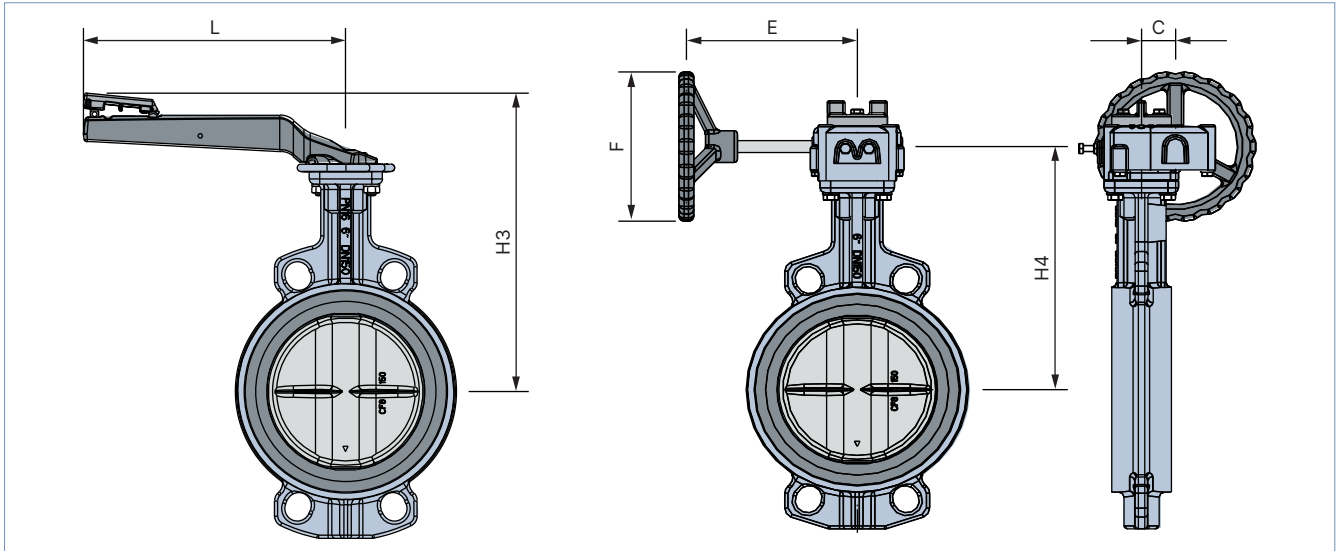

Size		Lever operator		Gear operator				Handwheel turns On/off	Mounting flange	
		H3	L	H4	C	E	F	N	Type	PCD
[mm]	[inch]	[mm]	[mm]	[mm]	[mm]	[mm]	[mm]	[mm]		
40	1½"	195	200	157	41	155	150	10	F07	70
50	2"	218	200	180	41	155	150	10	F07	70
65	2½"	230	200	192	41	155	150	10	F07	70
80	3"	237	200	199	41	155	150	10	F07	70
100	4"	256	200	218	41	155	150	10	F07	70
125	5"	272	250	234	41	155	150	10	F07	70
150	6"	285	250	247	41	155	150	10	F07	70
200	8"	324	355	281	63	195	200	9	F10	102

DTS 1000185213 EN Version: | Status: RL (released | freigegeben | valide) printed: 01.04.2026

4. Performance specifications

4.1. C_v value

Note:

C_v value denotes the flow rate in m³/h for water at + 68 °F (+ 20 °C) flowing under a pressure differential 1 kg/cm³.

Size		Valve open degree								
		10°	20°	30°	40°	50°	60°	70°	80°	90°
[mm]	[inch]	[gal/min]	[gal/min]	[gal/min]	[gal/min]	[gal/min]	[gal/min]	[gal/min]	[gal/min]	[gal/min]
40	1½"	0.8	2.8	8	16.6	25	42	69	94	132
50	2"	1.2	4.4	11.9	25	44	70	117	154	225
65	2½"	2.3	8.7	21	40	71	111	218	280	368
80	3"	2.9	11.4	30	56	97	147	250	395	497
100	4"	4.4	17	45	84	139	258	422	709	845
125	5"	7.6	28	72	138	253	460	700	1214	1454
150	6"	11.7	47	111	204	381	634	1021	1474	2175
200	8"	22	74	193	358	670	1164	1833	2702	3655

4.2. Expected seating/unseating torque (Nm) including 30 % safety factor

Note:

To use the torque chart, note the following:

- Seating/Unseating torque values above included friction bearing torque for stated ΔP .
- Do not apply a safety factor to above torque values when determining actuator output torque requirement.

Size		Lubricating (non-corrosive) ΔP				Dry (non-lubricating) ΔP		
		44	87	145	232	44	87	145
[mm]	[inch]	[psi]	[psi]	[psi]	[psi]	[psi]	[psi]	[psi]
40	1½"	15	17	19	23	19	21	23
50	2"	15	17	19	23	19	21	23
65	2½"	18	20	22	26	22	24	27
80	3"	28	31	34	41	34	38	42
100	4"	37	41	45	54	45	50	56
125	5"	61	68	76	91	76	84	93
150	6"	116	127	140	154	126	138	152
200	8"	171	190	211	253	211	234	260

4.3. Rubber lined butterfly valve specification chart

Note:

- Flange Class: ANSI 150
- D/A: Double-acting
- S/R: Spring return
- F/O: Fail open
- F/C: Fail closed
- See the electric actuator datasheet for complete options.

Size	Type	Style	Body	Seat	Disc	Stem	Operator	Limit Switch	Solenoid	Positioner
4.0"	1	1	1	2	1	1	1	A	0	A
1.5"	1 - rubber lined	1 - wafer	1 - ductile iron	1 - NBR (nitrile)	0 - ductile iron	1 - 410SS	0 - bare stem	A - none	0 - none	A - none
2.0"	-	2 - lug	2 - cast iron	2 - EPDM	1 - 316SS	2 - 304SS	1 - 10 position handle	B - SPDT	1 - 120/1/60 V AC	B - 4-20 Ma
2.5"	-	-	3 - 316SS	3 - white EPT	2 - 304SS	3 - 316SS	2 - gear operator	S - please specify	2 - 24 V DC	-
3.0"	-	-	-	4 - neo-prene (CR)	3 - alu-bronze	-	3 - pneumatic D/A	-	-	-
4.0"	-	-	-	5 - silicon	-	-	4 - pneumatic S/R F/C	-	-	-
5.0"	-	-	-	6 - hypalon (CSM)	-	-	5 - pneumatic S/R F/O	-	-	-
6.0"	-	-	-	7 - viton	-	-	6 - electric 120 V AC	-	-	-
8.0"	-	-	-	-	-	-	7 - electric 24 V DC	-	-	-

5. Ordering information

5.1. Bürkert eShop



Bürkert eShop – Easy ordering and quick delivery

You want to find your desired Bürkert product or spare part quickly and order directly? Our online shop is available for you 24/7. Sign up and enjoy all the benefits.

[Order online now](#)

5.2. Bürkert product filter



Bürkert product filter – Get quickly to the right product

You want to select products comfortably based on your technical requirements? Use the Bürkert product filter and find suitable articles for your application quickly and easily.

[Try out our product filter](#)

DTS 1000185213 EN Version: | Status: RL (released | freigegeben | valide) printed: 01.04.2026