



Ball valve made of cast 316 stainless steel, 2-way, 3-piece

- 2250 PSI WOG
- Thread and socket weld ends
- Full port to Sch 40 pipe
- Full lugged body
- Range of seal options
- Blow-out proof stem with self adjust packing
- ISO 5211 mounting flange

Product variants described in the data sheet may differ from the product presentation and description.

Can be combined with

	Type 2051 Pneumatic rotary actuator	▶
	Type 2053 Pneumatic rotary actuator for the automation of ball and butterfly valves	▶
	Type 3003 Electrical Rotary Actuator – On/Off and control	▶
	Type 3005 Electric Rotary Actuator – On/Off and Control	▶
	Type 3004 Explosion-Proof Rotary Actuator – On/Off or Control	▶
	Type 1061 Position feedback unit for pneumatic rotary actuators	▶
	Type 8692 Digital electropneumatic positioner for integrated mounting on process control valves	▶

Type description

This Burkert ball valve design is an industry proven three piece investment cast body with PTFE/FKM sealing. It finds wide use in fluid media while offering higher cycle life and reduced torque. The self-adjusting packing gland is a dual sealing type with an alignment collar for superior tightness.

The Type 2654 is automation ready with an ISO 5211 mounting pad for direct coupling of the actuator. A full range of actuators, pilots, digital positioners, feedback switches and bus network options are available for integration into plant control systems.

For maintenance, this design allows removal of all seals with just four bolts. The fully lugged body enhances the pressure rating and provides for easy re-assembly. The ball is full port style, presenting a CV and pressure drop similar to an open line, without restriction to high flow CIP or entrained solids.

DTS 1000152216 EN Version: E Status: RL (released | freigegeben | valide) printed: 01.04.2026

Table of contents

1. General technical data	3
2. Control functions	3
3. Materials	3
3.1. Bürkert resistApp	3
3.2. Material specifications	4
High pressure valve, size 1/4" ..3"	4
High pressure valve, size 1/4" ..3", exploded view	5
High pressure valve, size 4" ..6"	6
4. Dimensions	7
4.1. Valve size 1/4" ..3"	7
4.2. Valve size 4" ..6"	8
4.3. 2051 ISO connection / star adapter	9
4.4. Reducing sleeve	10
5. Performance specifications	11
5.1. Pressure temperature diagram	11
6. Product design and assembly	11
6.1. Product design	11
ISO direct mount	11
6.2. Product features	11
V-ball for modulating controller	11
7. Ordering information	12
7.1. Bürkert eShop	12
7.2. Bürkert product filter	12
7.3. Ordering chart for manual ball valves	13
7.4. Ordering chart for 2051 pneumatic actuators	13
Double-acting actuator (control function I) torque ratings (in-lbs)	13
Spring-return actuator (control function A/B)	13
7.5. Ordering charts for electric actuators	14
3003 Multi-voltage actuator On/Off variant	14
3003 Multi-voltage actuator control variant, input and output signals (programmable 0..10 V, 4..20 ma and 0..20 ma)	14
3005 Multi-voltage actuator On/Off variant	15
3005 Multi-voltage actuator control variant, input and output signals (programmable 0..10 V, 4..20 ma and 0..20 ma)	15
3004 Ex actuator On/Off variant (ATEX II 2 GD Ex d II B T6)	15
3004 Ex actuator control variant (ATEX II 2 GD Ex d II B T6), input and output signals (programmable 0..10 V, 4..20 ma and 0..20 ma)	15
7.6. Ordering chart for accessories	16
Reducing sleeve	16
NAMUR pilot valve 6519 with 5/2-way and 3/2-way	16
Limit switch boxes	16
Ordering chart for screw sets suitable for interface according to ISO 5211	16

DTS 1000152216 EN Version: E Status: RL (released | freigegeben | valide) printed: 01.04.2026

1. General technical data

Product properties	
Dimensions	Further information can be found in chapter "4. Dimensions" on page 7.
Materials	
Seal	TFM, DELRIN (ball seal, others to application)
Body	Stainless steel 1.4408/316 ¹⁾
Ball	Stainless steel 1.4401/316
Stem	Stainless steel 1.4401/316
Packing gland	Self-adjusting TFM and PEEK with stainless steel 304 guide/follower
Flow direction	Seals to rated pressure in both directions
Control functions	A, B and I Further information can be found in chapter "2. Control functions" on page 3.
Control option	Size to conditions or V port ball
Performance data	
Nominal pressure	2250 PSI: ¼"...3"
Medium data	
Medium temperature	- 50 °F...+ 220 °F (DELRIN) + 450 °F (TFM)
Operating medium	Compatible with materials of construction and pressure / temperature limits of seals
Viscosity	As torque effect allows
Product connections	
Port connection	NPT ¼"...NPT 3"
Port diameter class	Full port to Sch 40 pipe size
End connections	NPT: National pipe thread tapered Socket weld: to schedule pipe OD
Environment and installation	
Installation	As required

1.) Other valve body materials available to meet your specifications, contact your local Bürkert sales department for more information.

2. Control functions

Symbol	Description
	Control function A (CF A) Pneumatically operated 2/2-way on/off valve Flow direction above seat Normally closed by spring force
	Control function B (CF B) Single-acting actuator for pneumatically operated 2/2-way on/off valve Normally ed by spring force
	Control function I (CF I) Pneumatically operated 2/2-way on/off valve on either side Bidirectional Switching position dependent on external control

3. Materials

3.1. Bürkert resistApp

Bürkert resistApp – Chemical resistance chart

You want to ensure the reliability and durability of the materials in your individual application case? Verify your combination of media and materials on our website or in our resistApp.

[Start chemical resistance check](#)

DTS 1000152216 EN Version: E Status: RL (released | freigegeben | valide) printed: 01.04.2026

3.2. Material specifications

High pressure valve, size 1/4"...3"

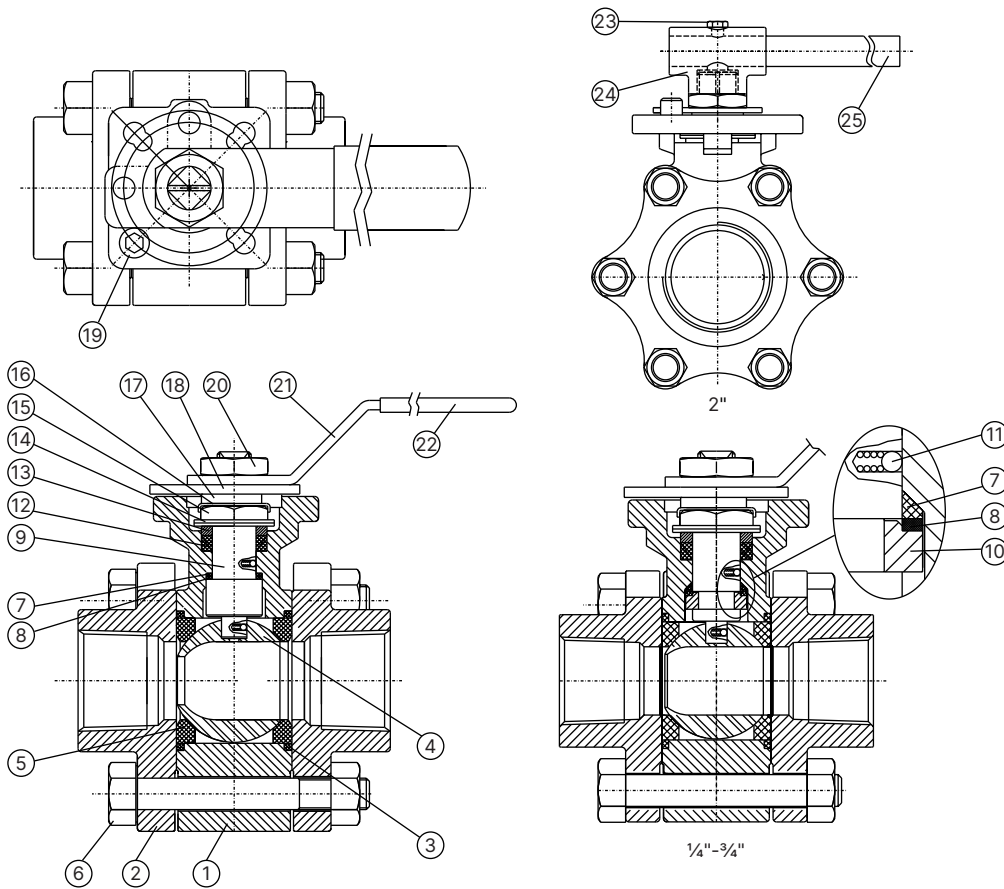

No.	Element	Material
1	Body	Stainless steel 1.4408/316
2	End cap	Stainless steel 1.4408/316
3	Gasket (body)	TFM
4	Ball	Stainless steel 1.4401/316
5	Ball Seats	TFM, DELRIN, PEEK
6	Bolts	Stainless steel 1.4301/304
7	Thrust washer	TFM
8	Thrust washer	PEEK
9	Stem	Stainless steel 1.4401/316
10	Half split ring	Stainless steel 1.4401/316
11	Anti-static	Stainless steel 1.4401/316
12	Stem packing	TFM
13	Gland washer	Stainless steel 1.4301/304
14	Disk washer	Stainless steel 1.4310/301
15	Stem nut	Stainless steel 1.4301/304
16	Nut stop	Stainless steel 1.4301/304
17	Space washer	Stainless steel 1.4301/304
18	Plater	Stainless steel 1.4301/304
19	Stop pin	Stainless steel 1.4301/304
20	Handle Nut	Stainless steel 1.4301/304
21	Handle	Stainless steel 1.4301/304
22	Handle cover	Plastic
23	Set bolt	Stainless steel 1.4301/304
24	Lever head	CF8
25	Lever	Steel pipe

DTS 1000152216 EN Version: E Status: RL (released | freigegeben | valide) printed: 01.04.2026

High pressure valve, size ¼"...3", exploded view

Note:

See material chart on page "High pressure valve, size ¼"...3" on page 4.

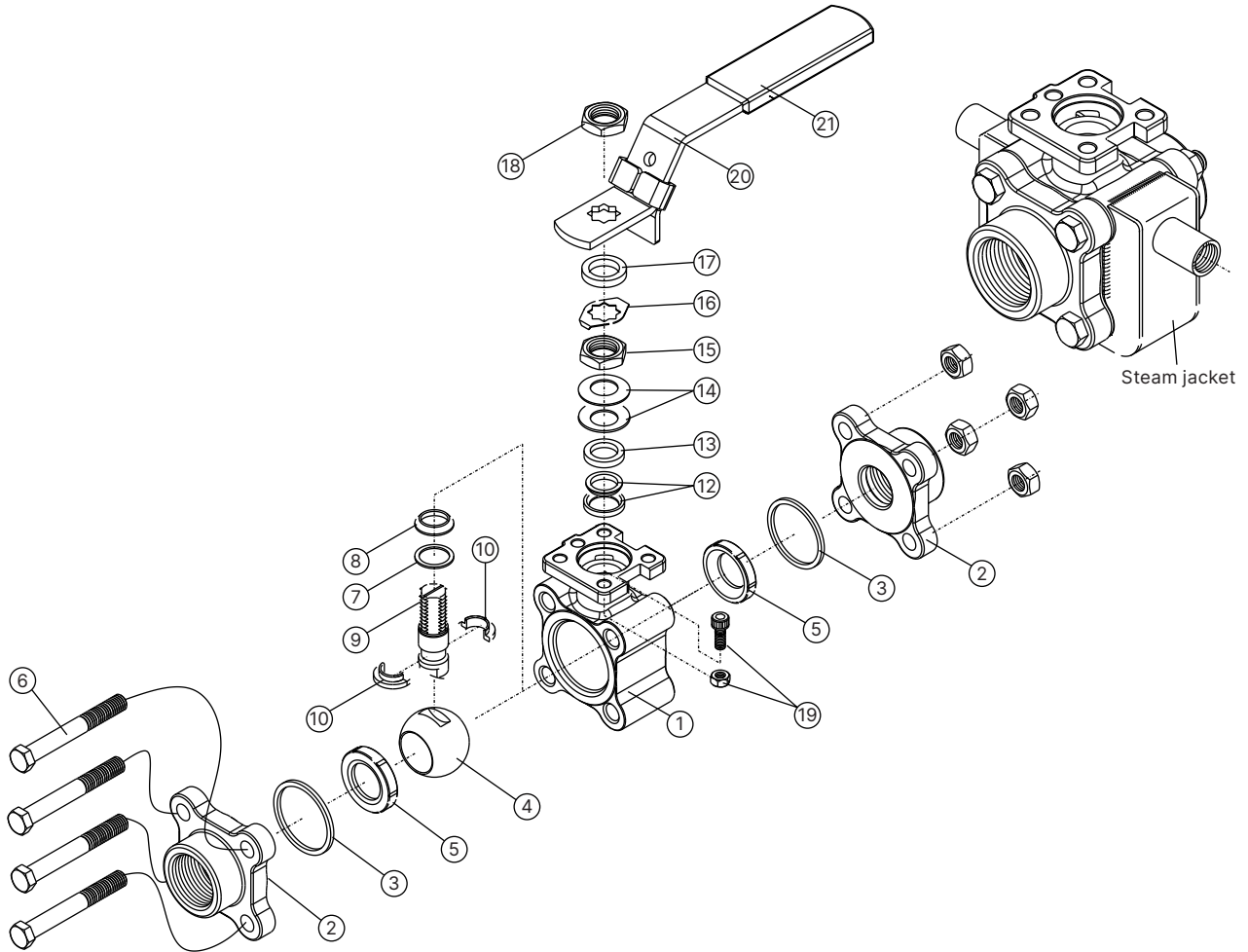

High pressure valve, size 4"...6"

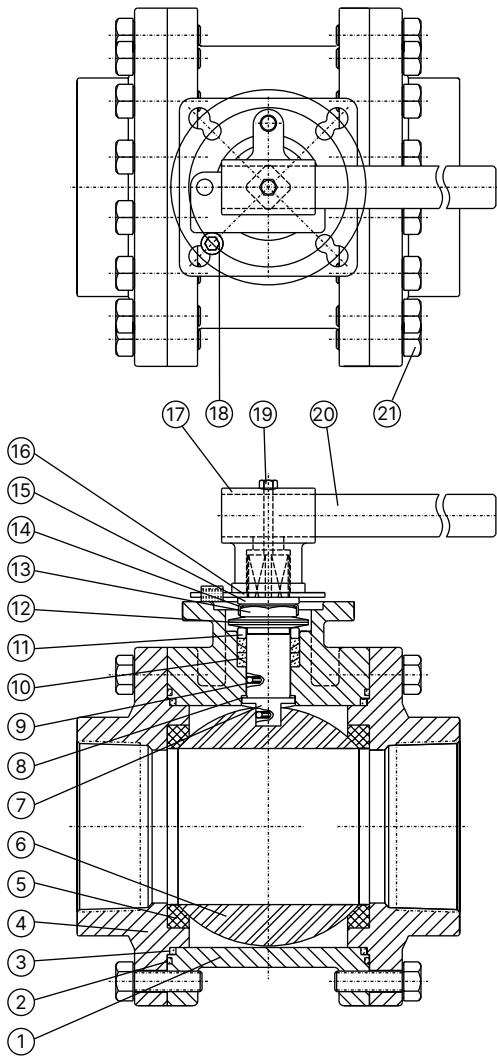

No.	Element	Material
1	Body	Stainless steel 1.4408/316
2	Gasket (big)	TFM
3	Gasket (small)	TFM
4	End cap	Stainless steel 1.4408/316
5	Ball Seats	TFM, DELRIN
6	Ball	Stainless steel 1.4401/316
7	Stem	17 - 4 PH
8	Thrust washer	PEEK
9	Anti-static	Stainless steel 1.4401/316
10	Stem packing	TFM
11	Gland washer	Stainless steel 1.4301/304
12	Disk washer	Stainless steel 1.4310/301
13	Stem nut	Stainless steel 1.4301/304
14	Nut stop	Stainless steel 1.4301/304
15	Space washer	Stainless steel 1.4301/304
16	Plater	Stainless steel 1.4301/304
17	Lever head	CF8
18	Stop pin	Stainless steel 1.4301/304
19	Set bolt	Stainless steel 1.4301/304
20	Lever	Steel pipe
21	Bolts	Stainless steel 1.4301/304

DTS 1000152216 EN Version: E Status: RL (released | freigegeben | valide) printed: 01.04.2026

4. Dimensions

4.1. Valve size 1/4" ... 3"

Note:

Dimensions in mm

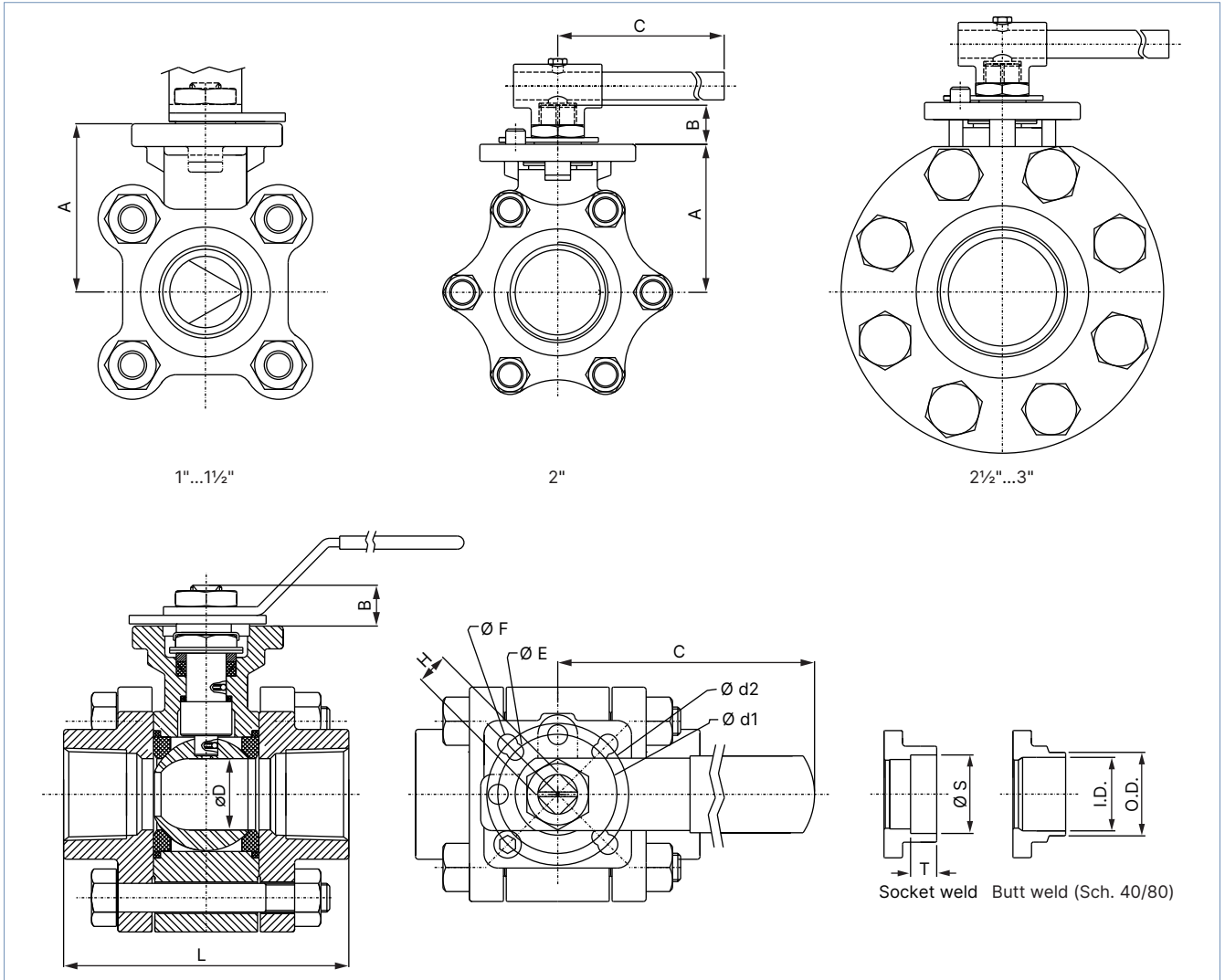

Size	A	B	C	D	d1	d2	E	F	H	L	SW		BW (40#)		BW (80#)	
											S	T	OD	ID	OD	ID
1/4"	46	9	130	11	6	6	36	42	9	66.5	14.2	11.1	14	9.2	14	7.5
3/8"	46	9	130	12.5	6	6	36	42	9	66.5	17.5	11.1	17	12.7	17	10.8
1/2"	48	9	130	15	6	6	36	42	9	70	21.8	12.7	21.3	15.9	21.3	13.8
3/4"	53	12	155	20	6	6	42	50	11	92	27.1	14.3	26.7	20.6	26.7	18.9
1"	59	12	155	25	6	7	42	50	11	105	33.8	15.9	33.3	26.6	33.3	24.3
1 1/4"	62	14.5	205	32	7	9.2	50	70	14	111	42.5	17.5	42.2	35.1	42.2	32.5
1 1/2"	70	14.5	205	38	7	9.2	50	70	14	124	48.7	18.3	48.5	40.5	48.5	38.1
2"	90	19	300	50	9.2	11.4	70	102	17	150	61.1	21.3	60.5	52.4	60.5	49.3
2 1/2"	105	18	350	63.5	9.2	11.4	70	102	17	165	73.9	22.2	73.2	62.7	73.2	59
3"	119	25	400	78	11.4	13.5	102	125	22	195	89.9	25.4	89.2	78	89.2	73.7

DTS 1000152216 EN Version: E Status: RL (released | freigegeben | valide) printed: 01.04.2026

4.2. Valve size 4"…6"

Note:

Dimensions in mm

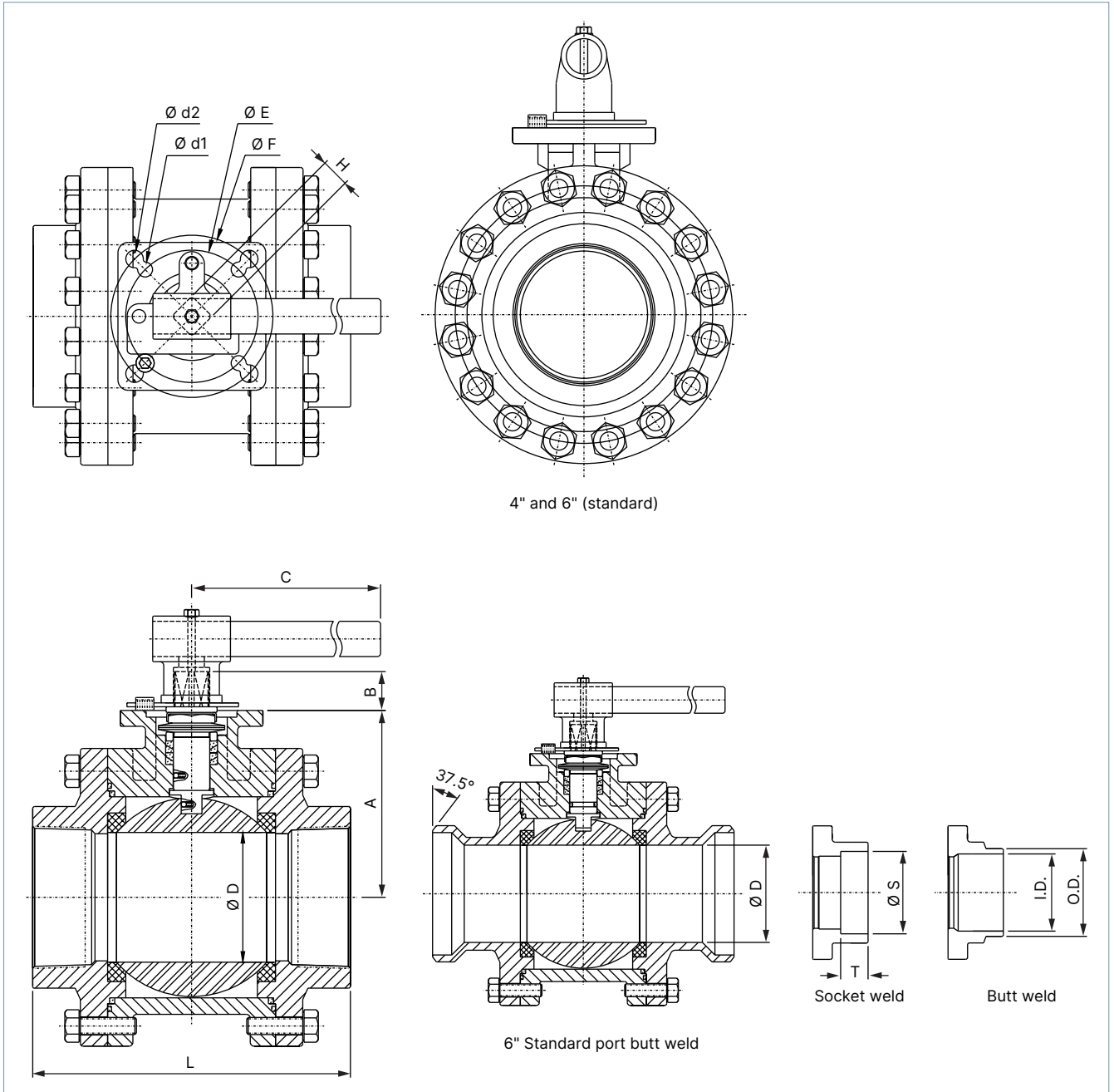

4" and 6" (standard)

6" Standard port butt weld

Socket weld

Butt weld

Size	A	B	C	D	d1	d2	E	F	H	L	SW		BW (40#)		BW (80#)		BW (160#)	
											S	T	OD	ID	OD	ID	OD	ID
4"	144	25	380	99	11.5	13.5	102	125	22	245	115.2	32	114.5	102.2	114.5	97.2	114.5	87.3
6" (std)	144	25	380	99	11.5	13.5	102	125	22	310	-	-	168.3	154	168.3	146.3	168.3	131.7

DTS 1000152216 EN Version: E Status: RL (released | freigegeben | valide) printed: 01.04.2026

4.3. 2051 ISO connection / star adapter

Note:

Dimensions in mm

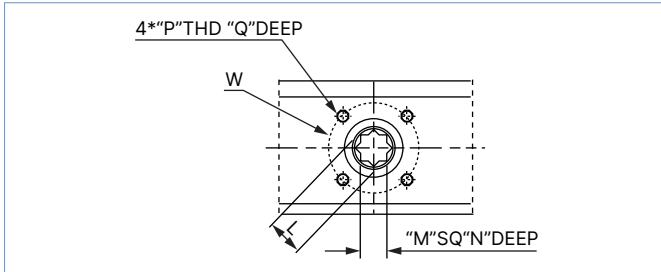

Actuator size	Interface acc. to ISO 5211	L	M	N	P	Q	W
125	F04	12.5	9	10	MxP0.8	8	42
250	F04 or F05	14.5	11	17	M5xP0.8/M6xP1.0	8.0/10.0	42.0/50.0
450	F05, F07	18.8	14	21	M6xP1.0/M8xP1.25	10.0/12.0	50.0/70.0
1000	F05, F07	23	17	25.5	M6xP1.0/M8xP1.25	10.0/12.0	50.0/70.0
2250	F07, F10	29.5	22	31	M8xP1.25/M10xP1.5	12.0/15.0	70.0/102.0
3650	F10, F12	35.5	27	35	M10xP1.5/M12xP1.75	15.0/19.0	102.0/125.0
5000	F10, F12	35.5	27	35	M10xP1.5/M12xP1.75	15.0/19.0	102.0/125.0
11000	F14	47.5	36	45	M16xP2.0	24	140

DTS 1000152216 EN Version: E Status: RL (released | freigegeben | valide) printed: 01.04.2026

4.4. Reducing sleeve

Note:

Dimensions in mm

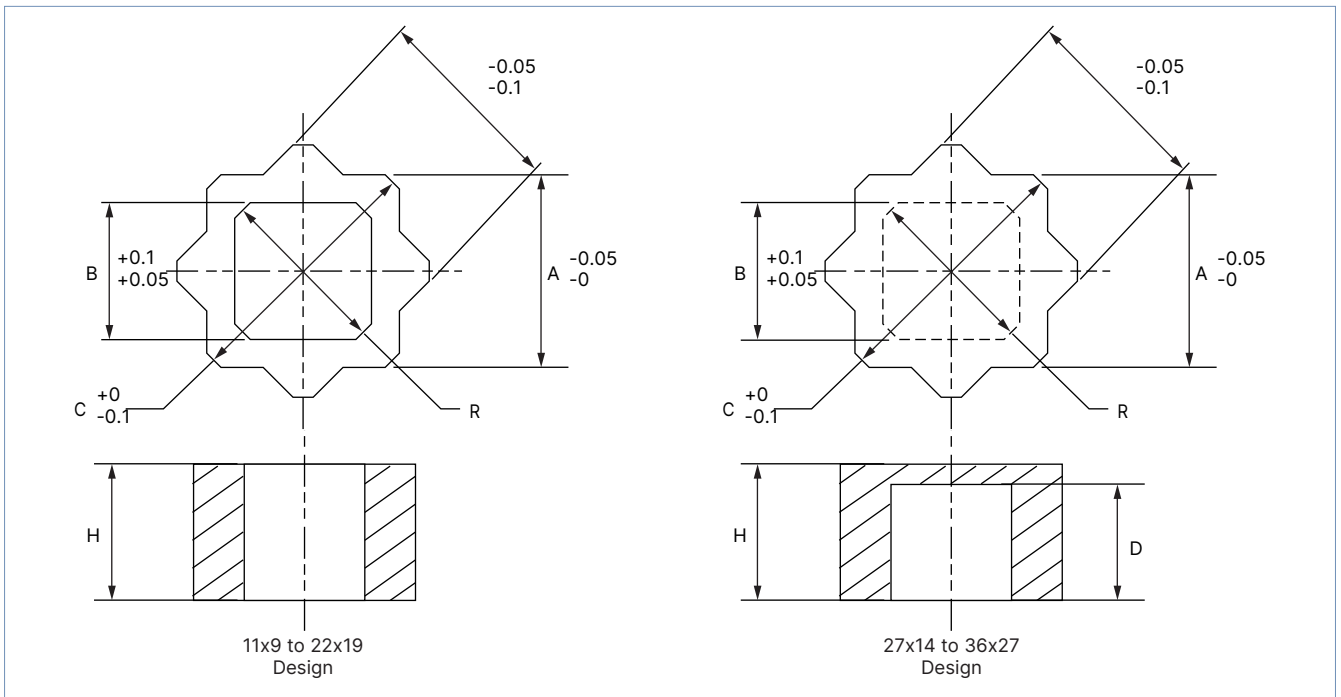
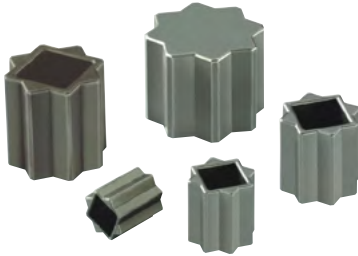

Insert	A	B	C	D	H	R	Article no.
11 × 9	11	9	15	–	17	12.5	98125211
14 × 9	14	9	19.1	–	20	12.5	665288
14 × 11	14	11	19.1	–	20	14.5	665289
17 × 9	17	9	23.1	–	24	12.5	98125212
17 × 11	17	11	23.1	–	24	14.5	98125213
17 × 14	17	14	23.1	–	24	19.2	665290
22 × 14	22	14	29.6	–	30	19.2	666684
22 × 17	22	17	29.6	–	30	23.3	666685
27 × 14	27	14	36	27	29	19.2	98125214
27 × 17	27	17	36	27	29	23.3	98125215
27 × 22	27	22	36	27	29	30	98125216
36 × 27	36	27	48	33	35	37	98125217

DTS 1000152216 EN Version: RL (released | freigegeben | valide) printed: 01.04.2026

5. Performance specifications

5.1. Pressure temperature diagram

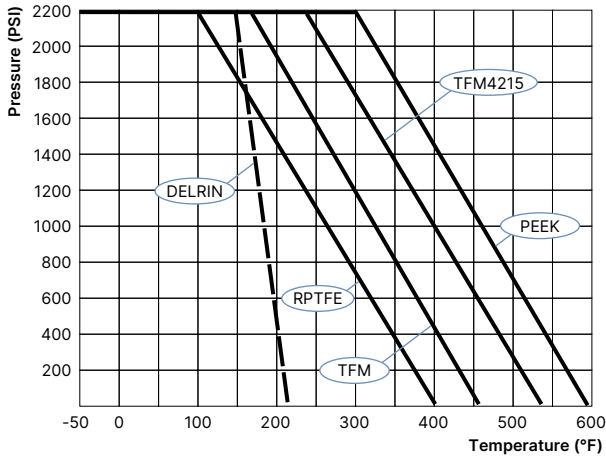

6. Product design and assembly

6.1. Product design

ISO direct mount

ISO direct mount for directly assembling actuator:

- Pneumatic (DA or SR) – Electric actuator
- Solenoid valve – Limit Switch Box – EP

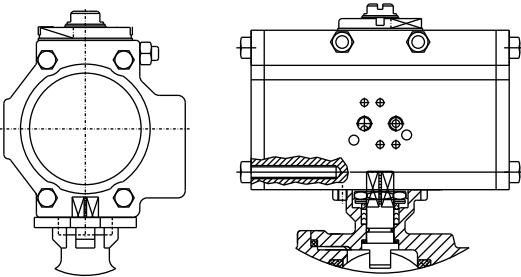

6.2. Product features

V-ball for modulating controller

Straight port	15° V-port	30° V-port	60° V-port	90° V-port

DTS 1000152216 EN Version: E Status: RL (released | freigegeben | valide) printed: 01.04.2026

7. Ordering information

7.1. Bürkert eShop



Bürkert eShop – Easy ordering and quick delivery

You want to find your desired Bürkert product or spare part quickly and order directly? Our online shop is available for you 24/7. Sign up and enjoy all the benefits.

[Order online now](#)

7.2. Bürkert product filter





Bürkert product filter – Get quickly to the right product

You want to select products comfortably based on your technical requirements? Use the Bürkert product filter and find suitable articles for your application quickly and easily.

[Try out our product filter](#)

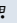
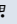
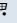
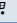
7.3. Ordering chart for manual ball valves

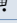
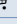
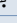
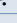
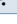

Port connections	Orifice	C _v	Seat material	WOG	Break torque value at 0 PSI		Interface acc. to ISO 5211	Article no.
					Lubed	Non-lubed		
NPT	[mm]	[gal/min]		[psi]	[Nm (in/lb)]	[Nm (in/lb)]		
1/4"	11.0	7.5	PTFE	2250	8.0 (71)	5.0 (44)	F03, F04	98124918 
3/8"	12.5	7.5	PTFE	2250	8.0 (71)	5.0 (44)	F03, F04	98124919 
1/2"	15.0	16.0	PTFE	2250	12.0 (106)	6.0 (53)	F03, F04	98124920 
3/4"	20.0	40.0	PTFE	2250	15.0 (133)	7.0 (62)	F03, F04	98124921 
1"	25.0	70.0	PTFE	2250	18.0 (159)	9.5 (84)	F04, F05	98124922 
1 1/4"	32.0	110.0	PTFE	2250	25.0 (221)	16.0 (142)	F04, F05	98124923 
1 1/2"	38.0	240.0	PTFE	2250	47.0 (416)	27.0 (239)	F05, F07	98124924 
2"	50.0	400.0	PTFE	2250	83.0 (735)	30.0 (266)	F05, F07	98124925 
2 1/2"	63.5	700.0	PTFE	2250	165.0 (1460)	68.0 (602)	F07, F10	98124926 
3"	78.0	980.0	PTFE	2250	250.0 (2213)	85.0 (752)	F07, F10	98124927 

7.4. Ordering chart for 2051 pneumatic actuators



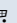

Note:

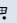
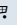
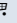
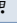
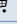
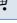
When selecting an actuator we suggest a 20 % to 40 % above the break torque of the valve (subject to the valve and operating conditions). For other specifications, dimensions, and electrical connections see specific datasheets.

Double-acting actuator (control function I) torque ratings (in-lbs)

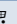
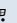
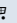
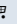
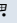
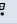
Actuator size	Air torque output at operating pressure [Psig]					Article no.
	40	60	80	100	120	
125	63	94	125	156	188	98124996 
250	125	187	250	312	375	98124997 
450	225	337	450	562	675	98124998 
1000	500	750	1000	1250	1500	98124999 
2250	1125	1687	2250	2812	3375	98125000 
3650	1825	2738	3650	4563	5475	98125001 
5000	2500	3750	5000	6250	7500	98125002 
11000	5500	8250	11000	13750	16500	98125003 

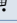
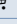
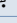
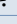
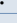
Spring-return actuator (control function A/B)

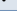





Actuator size	Spring set	Spring torque		Air torque output at operating pressure [Psig]								Article no.
		Start	End	60		80		100		120		
				Start	End	Start	End	Start	End	Start	End	
125	R3	104	67	113	70	176	133	229	195	301	258	98124976 
	R4	140	90	88	31	151	93	213	156	276	218	98124977 
450	R3	190	121	203	125	316	238	428	350	541	463	98124978 
	R4	254	162	158	54	271	167	383	279	496	392	98124979 
1000	R3	418	270	449	278	698	526	947	775	1196	1025	98124980 
	R4	559	360	350	120	599	371	848	618	1097	867	98124981 
2250	R3	990	590	1034	591	1596	1154	2159	1717	2722	2280	98124984 
	R4	1320	787	816	226	1379	788	2029	1351	2505	1914	98124986 
3650	R3	1573	912	1726	996	2637	1907	3549	2819	4460	3730	98124988 
	R4	2091	1217	1388	423	2300	1335	3211	2246	4123	3157	98124989 
5000	R3	2340	1180	2380	1200	3570	2400	4760	3590	5960	4780	98124990 
	R4	3130	1570	1980	414	3180	1600	4370	2800	5560	3990	98124991 
11000	R3	5100	2570	5200	2650	7790	5240	10400	7840	13000	10400	98124992 
	R4	6790	3430	4330	932	6930	3530	9520	6130	12100	8730	98124993 

7.5. Ordering charts for electric actuators

Note:

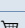
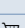

When selecting the on/off variant, we recommend a safety torque equal to 1.5 times the max break torque of the valve, and for the control variant we recommend a safety torque equal to 2 times the max break torque of the valve. For other specifications, dimensions, and electrical connections see specific datasheets.

3003 Multi-voltage actuator On/Off variant

Drive stars	Reducing sleeve included	Interface acc. to ISO 5211	Torque	90° rotation time ± 1 s	Power consumption	Voltage / frequency	Article no.
[mm]	[mm]		[Nm]	[s]	[W]		
14	14/11, 14/9	F05 (F03, F04)	20	12	15	15...30 V AC, 50/60 Hz / 12...24 V DC ¹⁾	225192 
14	14/11, 14/9	F05 (F03, F04)	20	12	15	100...240 V AC, 50/60 Hz / 100...350 V DC	225193 
22	22/14	F05-F07	35	7	45	15...30 V AC, 50/60 Hz / 12...24 V DC ¹⁾	225194 
22	22/14	F05-F07	35	7	45	100...240 V AC, 50/60 Hz / 100...350 V DC	225195 
22	22/14	F05-F07	60	12	45	15...30 V AC, 50/60 Hz / 12...24 V DC ¹⁾	225196 
22	22/14	F05-F07	60	12	45	100...240 V AC, 50/60 Hz / 100...350 V DC	225197 
22	22/17	F05-F07	100	23	45	15...30 V AC, 50/60 Hz / 12...24 V DC ¹⁾	225198 
22	22/17	F05-F07	100	23	45	100...240 V AC, 50/60 Hz / 100...350 V DC	225225 

1.) The operating voltage must not fall below 11.5 V

3003 Multi-voltage actuator control variant, input and output signals (programmable 0...10 V, 4...20 ma and 0...20 ma)

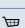
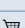
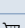
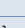
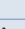
Drive stars	Reducing sleeve included	Interface acc. to ISO 5211	Torque	90° rotation time ± 1 s	Power consumption	Voltage / frequency	Article no.
[mm]	[mm]		[Nm]	[s]	[W]		
14	14/11, 14/9	F05 (F03, F04)	20	25	15	15...30 V AC, 50/60 Hz / 12...24 V DC ¹⁾	225199 
14	14/11, 14/9	F05 (F03, F04)	20	25	15	100...240 V AC, 50/60 Hz / 100...350 V DC	225200 
22	22/14	F05-F07	35	40	45	15...30 V AC, 50/60 Hz / 12...24 V DC ¹⁾	225201 
22	22/14	F05-F07	35	40	45	100...240 V AC, 50/60 Hz / 100...350 V DC	225202 
22	22/14	F05-F07	60	79	45	15...30 V AC, 50/60 Hz / 12...24 V DC ¹⁾	225203 
22	22/14	F05-F07	60	79	45	100...240 V AC, 50/60 Hz / 100...350 V DC	225204 
22	22/17	F05-F07	100	119	45	15...30 V AC, 50/60 Hz / 12...24 V DC ¹⁾	225205 
22	22/17	F05-F07	100	119	45	100...240 V AC, 50/60 Hz / 100...350VDC	225206 

1.) The operating voltage must not fall below 11.5 V

3005 Multi-voltage actuator On/Off variant

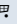
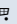
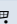
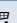
Drive stars	Reducing sleeve included	Interface acc. to ISO 5211	Torque	90° rotation time ± 1 s	Power consumption	Voltage / frequency	Article no.
[mm]	[mm]		[Nm]	[s]	[W]		
22	22/17	F07-F10	150	30	45	100...240 V AC, 50/60 Hz	181303 
22	22/17	F07-F10	150	30	45	24 V AC/DC	181304 
22	22/17	F07-F10	300	50	85	100...240 V AC, 50/60 Hz	181305 
22	22/17	F07-F10	300	50	85	24 V AC/DC	181306 



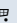
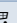
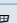

3005 Multi-voltage actuator control variant, input and output signals (programmable 0...10 V, 4...20 ma and 0...20 ma)

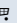
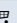
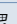
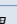
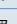
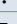
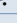
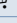
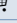
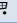
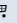
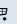
Drive stars	Reducing sleeve included	Interface acc. to ISO 5211	Torque	90° rotation time ± 1 s	Power consumption	Voltage / frequency	Article no.
[mm]	[mm]		[Nm]	[s]	[W]		
22	22/17	F07-F10	150	30	45	100...240 V AC, 50/60 Hz	181293 
22	22/17	F07-F10	150	30	45	24 V AC/DC	179725 
22	22/17	F07-F10	300	50	85	100...240 V AC, 50/60 Hz	181307 
22	22/17	F07-F10	300	50	85	24 V AC/DC	179726 

3004 Ex actuator On/Off variant (ATEX II 2 GD Ex d II B T6)

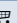
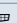
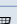
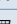
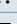
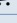
Drive stars	Reducing sleeve included	Interface acc. to ISO 5211	Torque	90° rotation time ± 1 s	Power consumption	Voltage / frequency	Article no.
[mm]	[mm]		[Nm]	[s]	[W]		
17	17/11	F05-F07	25	7	45	100...240 V AC, 50/60 Hz	181308 
17	17/11	F05-F07	25	7	45	24 V AC/DC	181309 
17	17/14	F05-F07	45	15	45	100...240 V AC, 50/60 Hz	181310 
17	17/14	F05-F07	45	15	45	24 V AC/DC	181311 
17	17/14	F05-F07	75	20	45	100...240 V AC, 50/60 Hz	181312 
17	17/14	F05-F07	75	20	45	24 V AC/DC	181313 
22	22/17	F07-F10	100	15	45	100...240 V AC, 50/60 Hz	181314 
22	22/17	F07-F10	100	15	45	24 V AC/DC	181315 
22	22/17	F07-F10	150	30	45	100...240 V AC, 50/60 Hz	181316 
22	22/17	F07-F10	150	30	45	24 V AC/DC	181317 
22	22/17	F07-F10	300	50	85	100...240 V AC, 50/60 Hz	181318 
22	22/17	F07-F10	300	50	85	24 V AC/DC	181319 

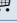
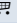
3004 Ex actuator control variant (ATEX II 2 GD Ex d II B T6), input and output signals (programmable 0...10 V, 4...20 ma and 0...20 ma)

Drive stars	Reducing sleeve included	Interface acc. to ISO 5211	Torque	90° rotation time ± 1 s	Power consumption	Voltage / frequency	Article no.
[mm]	[mm]		[Nm]	[s]	[W]		
17	17/11	F05-F07	25	15	45	100...240 V AC, 50/60 Hz	182324 
17	17/11	F05-F07	25	15	45	24 V AC/DC	182326 
17	17/14	F05-F07	45	15	45	100...240 V AC, 50/60 Hz	182327 
17	17/14	F05-F07	45	15	45	24 V AC/DC	182330 
17	17/14	F05-F07	75	20	45	100...240 V AC, 50/60 Hz	182335 
17	17/14	F05-F07	75	20	45	24 V AC/DC	182384 
22	22/17	F07-F10	100	15	45	100...240 V AC, 50/60 Hz	182385 
22	22/17	F07-F10	100	15	45	24 V AC/DC	182386 
22	22/17	F07-F10	150	30	45	100...240 V AC, 50/60 Hz	182388 
22	22/17	F07-F10	150	30	45	24 V AC/DC	182390 
22	22/17	F07-F10	300	50	85	100...240 V AC, 50/60 Hz	182392 
22	22/17	F07-F10	300	50	85	24 V AC/DC	182394 

7.6. Ordering chart for accessories

Reducing sleeve







Note:

Further ordering information can be found in chapter "4.4. Reducing sleeve" on page 10.

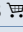
NAMUR pilot valve 6519 with 5/2-way and 3/2-way

Note:



For other specifications, dimensions and electrical connections see specific datasheets.

Circuit function	Orifice [mm]	Q _{Nn} valve air [l/min]	C _v [gal/min]	Seal material	Socket connection material	Voltage / frequency	Article no.
CF W	6.0	900	1.3	NBR, PUR	Nickel-plated brass	24 V DC, 2 W	132727 
						24 V 60 Hz, 2 W	420843 
						120 V 60 Hz, 2 W	420844 
						240 V 60 Hz, 2 W	420845 
CF W	6.0	900	1.3	NBR, PUR	Stainless Steel	24 V DC, 2 W	458411 
						24 V 60 Hz, 2 W	458410 
						120 V 60 Hz, 2 W	458412 
						240 V 60 Hz, 2 W	458413 

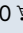
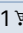
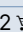
Limit switch boxes

Type	Ambient temperature	Protection class	Position feedback	Position indicator	Cable entry	Article no.
APL-210 N	- 4 °F...+ 176 °F (- 20 °C...+ 80 °C)	IP67/NEMA 4 and 4X	2 SPDT Mechanical	Closed (red), Open (yellow)	2 x 1/2" NPT	98125280 
E-07	- 4 °F...+ 185 °F (- 20 °C...+ 85 °C)	Ex d IIC T6	2 SPDT Mechanical	Closed (red), Open (yellow)	2 x 3/4" NPT	98125281 
APL-510 N	- 4 °F...+ 140 °F (- 20 °C...+ 60 °C)	IP67/NEMA 4, 4X, 7, 9 E Ex d IIC T6	2 SPDT Mechanical	Closed (red), Open (yellow)	2 x 3/4" NPT	98125282 

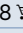
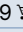
Ordering chart for screw sets suitable for interface according to ISO 5211

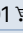
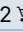
Interface acc. to ISO 5211	4 x socket set screw DIN 916 A2 S/S 18 - 8	Includes 4 x flat washer DIN 125 A4 S/S 18 - 8	4 x metric hex nut DIN 934 A2 S/S 18 - 8	Article no.
	[mm]	[mm]	[mm]	
F04	M5 - 0.8 × 25	M5 - 5.3 × 10	M5 - 0.8 × 8 × 4	98125298 
F05	M6 - 1 × 25	M6 - 6.4 × 12	M6 - 1 × 10 × 5	98125299 
F07	M8 - 1.25 × 25	M8 - 8.4 × 16	M8 - 1.25 × 13 × 6.5	98125300 
F10	M10 - 1.5 × 35	M10 - 10.5 × 20	M10 - 1.5 × 17 × 8	98125301 
F12	M12 - 1.75 × 40	M12 - 13 × 24	M12 - 1.75 × 19 × 10	98125302 
F14	M16 - 2 × 40	M16 - 17 × 28	M16 - 2 × 24 × 13	98125303 